

#### Features

Remote **Color Touchscreen LCD** annunciators for use with Simplex® model 4007ES fire alarm control panels

#### 4.3" (109 mm) diagonal color touchscreen display:

- Provides the display features of the 4007ES fire alarm control panel at a remote location
- Convenient and intuitive user interface provides detailed system status and individual point information
- LED status indicators include Alarm, Priority 2, Supervisory, Trouble, Alarm Silenced, and Status of AC Power at the control panel
- Supports dual language selection, including unicode character languages
- Keyswitch is used to enable default access level; additional user access levels are passcode protected; keyswitch and user access levels are configurable
- Tone-alert sounder provides local audible indication
- Three programmable control switches with status LEDs and provisions for custom labeling

#### Additional features:

- Available with platinum or red trim
- Information is transmitted over a single unshielded twisted pair; separate wiring is required for 24 VDC power
- Mounts flush on RACO 944, 5-gang electrical box (supplied separately)
- Up to 6 Color Touchscreen LCD Annunciators per 4007ES fire alarm control panel

**Mounting box options** (ordered separately, see page 2 for more details):

- Surface mount boxes in red or platinum
- Semi-flush mount boxes in red or platinum, may be used for legacy annunciator retrofit applications

#### Description

**Local Annunciation and Control.** 4606-9200 Series LCD Annunciators allows 4007ES fire alarm control panels to provide information and control switches at convenient locations away from the control panel. The color touchscreen LCD with backlighting displays information in clear and descriptive language. (English is standard, other languages can be programmed.) Typical content includes: point status (alarm, trouble, etc.), alarm type (smoke detector, manual station, etc.), number of system alarms, supervisory conditions, troubles, and custom location labels up to 40 characters long.

**Communications.** Data communications require a single unshielded twisted pair that supports other annunciators on the same communications channel.

\* This product has been approved by the California State Fire Marshal (CSFM) pursuant to Section 13144.1 of the California Health and Safety Code. See CSFM Listing 7300-0026:0382 for allowable values and/or conditions concerning material presented in this document. NYC Fire Dept COA #6191A. Additional listings may be applicable; contact your local Simplex product supplier for the latest status. Listings and approvals under Simplex Time Recorder Co. are the property of Tyco Fire Protection Products.



4606-9205 LCD Annunciator with Platinum Trim



4606-9202 LCD Annunciator with Red Trim

#### Description (Continued)

**Indications.** Alarm, Priority 2, Supervisory, Trouble, and Alarm Silenced conditions are indicated by dedicated LEDs and a tone-alert audible indication. Each condition will cause the display to present a dedicated acknowledge push-button switch that silences the tone-alert but leaves the LED on until all conditions in that category are restored to normal.

**Custom Background.** The 4007ES control panel supports a custom background image that is also displayed on each of the color touchscreen annunciators when status is normal. File types supported are JPG, BMP, GIF, and PNG. Recommended image type is JPG, recommended image size is 480 x 240, and the file size limit is 100 kb.

#### Operation

**Keyswitch Access.** Touchscreen display access can be controlled by a keyswitch with a key that is removable only in the disabled position. Access is configurable per annunciator.

**Enabled Operations.** When the keyswitch is on, system status indications will be displayed as they occur with individual point detail as programmed at the control panel, and soft keys will be displayed to allow user actions.

**Screen Backlight.** When the display has not been touched, and no new system status has occurred for 60 seconds, the backlight dims to 20% of normal brightness. If there is no activity in the system (System is Normal), the standby screen displays current time and date to verify proper operation. If an event occurs, or with the keyswitch activated, and the screen is touched, the backlight returns to full intensity.

**Lamp Test.** The display menu provides a lamp test feature that when selected, activates the 9 panel LEDs for 5 seconds. Dual-color LEDs will blink alternately.

## Product Selection

Model*	Color	Description	Dimensions
4606-9202(BA)	Red	Remote Color Touchscreen LCD Annunciator; for flush mounting in a 5-gang RACO 944 box, or equal, supplied separately	<b>Annunciator:</b> 13" W x 5.21" H x 2" D (330 mm x 132 mm x 51 mm)
4606-9205(BA)	Platinum		<b>RACO 944 Box (reference):</b> 12 1/4" W x 4 1/2" H x 2 1/2" D (311 mm x 114 mm x 64 mm)
2975-9461	Red	Surface mount metal box for above annunciators	12 1/4" W x 4 1/2" H x 2 1/2" D (311 mm x 114 mm x 64 mm)
2975-9462	Platinum		
2975-9463	Red	Semi-flush mount metal box adapter for above annunciators; use for mounting on existing 2-gang, 4-gang, 6-gang, or 4" (102 mm) square flush mounted boxes	12 1/4" W x 4 1/2" H x 1 3/4" D (311 mm x 114 mm x 44 mm)
2975-9464	Platinum		

\* Models with (BA) are available assembled in the USA by adding the suffix "BA".

## Suppression Products

Note: Suppression is required where annunciator communications and power wiring exits and enters a building

Model	Description	Additional Reference
2081-9044	Overvoltage Protector, rated for up to 200 mA; use for RUI communications	Data Sheet S2081-0016
2081-9028	Isolated Loop Circuit Protector (ILCP), rated for 5 A maximum; use for 24 VDC power wiring when above 200 mA	Data Sheet S2081-0008

## Operator Information

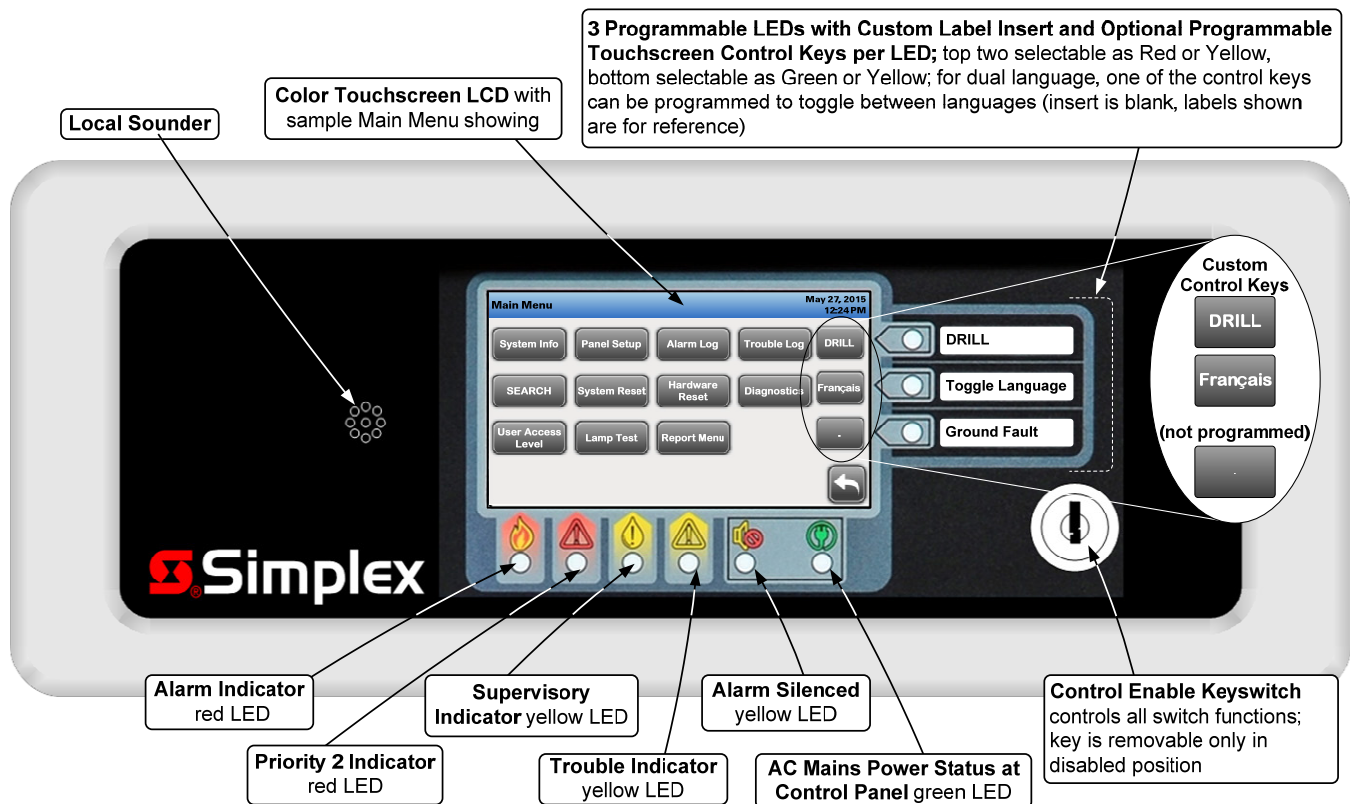

## Specifications

### General Operating Specifications

Voltage	18 to 32 VDC, system supplied		
Current Details	<b>Condition</b>	<b>Current</b>	<b>Details</b>
	Alarm	124 mA	Backlight at full intensity and tone-alert sounding
	Display Active	70 mA	Backlight at full intensity, occurs when activity is in process
	Standby	45 mA	Backlight dimmed to 20% of full intensity, occurs after 1 minute of no system activity
Operating Temperature Range	32° to 120° F (0° to 49° C)		
Operating Humidity Range	Up to 93% RH, non-condensing at 100° F (38° C)		

### Communications

For 4007ES Panels	Type	RUI (Remote Unit Interface) external annunciator communications line SLC (signaling line circuit)
	Capacity	Up to 6 Color Touchscreen LCD Annunciators

### Wiring Requirements

RUI Data	Standard Wiring Type	Unshielded twisted pair (UTP), 18 AWG (0.82 mm <sup>2</sup> ) for most applications, see below
	Wiring Characteristics	0.58 µF (580 nF) maximum capacitance between conductors; 35 Ω maximum total line resistance
	<b>Wiring Applications Requiring Shielded, Twisted Pair (STP)</b>	<ol style="list-style-type: none"> <li>1. Wiring that leaves the building. RUI wiring also requires 2081-9044 Overvoltage Protectors on each end.</li> <li>2. Wiring run in 500 ft (152 m) or more of conduit.</li> <li>3. Wiring closely bundled with standard IDNet communications or TrueAlert addressable communications (not required when run with IDNet+ communications).</li> </ol>
	Class B "T-Tap" wiring distance	Up to 10,000 ft (3048 m) total wiring; up to 2500 ft (762 m) to farthest device
	Class X wiring distance	Up to 2500 ft (762 m)
Power Wiring	Terminals for 18 to 12 AWG (0.82 mm <sup>2</sup> to 3.31 mm <sup>2</sup> ) wires for 24 VDC system power	
Earth Wiring	A dedicated earth ground connection to the electrical box is required for proper ESD and EMI protection; wire in accordance with NFPA 70 ( <i>National Electrical Code</i> ) Article 250	

### Mounting Information

Boxes for Flush Mounting (supplied separately)	5-gang masonry box, RACO # 944, 2 ½" (64 mm) deep or equal
--	--

### Additional Reference

Installation Instructions	579-1172
4007ES Data Sheets	S4007-0001, 4007ES Hybrid
	S4007-0002, 4007ES with IDNAC Notification

## Operator Screen Reference (shown approximately full size, refer to page 4 for additional screen reference)



# Operator Screen Reference

**Main Menu Screen** provides easy navigation to the function required. Buttons A, B, and C have programmable functions.

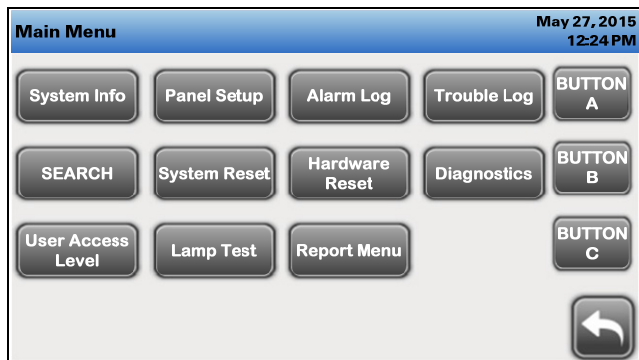

**System Alarm Screen** identifies active alarms with custom labels displayed, arrows allow navigation through the list



**System Trouble Screen** identifies active troubles with custom labels displayed, arrows allow navigation through the list

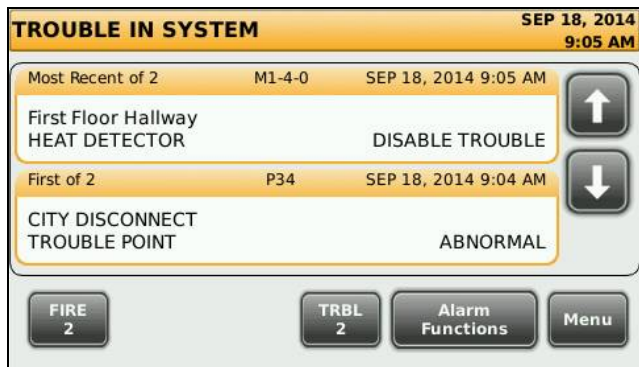

**Trouble Log Screen** allows review of past troubles with time stamp and point details shown.

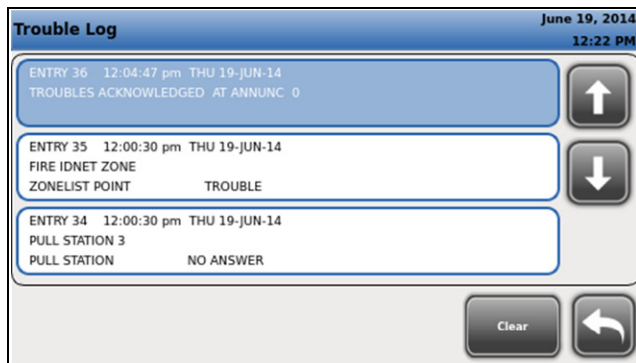

**Point Information Screen** allows review of point details, arrows allow navigation through the information.

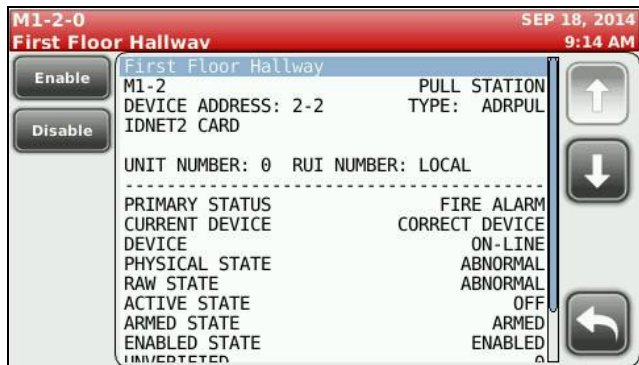

**User Access Login Screen** controls access to panel operations as determined per panel.

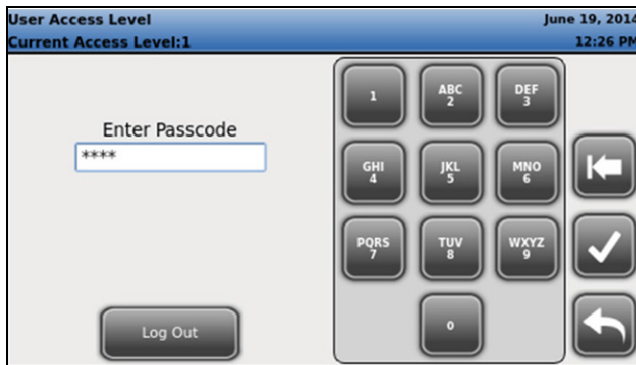

## Mounting Information

**Surface Mounting:** Use Simplex Surface Mount Box Model 2975-9461 (red) or 2975-9462 (platinum), 2-1/2" deep (64 mm) (ordered separately)

**Flush Mounting:** Use 5-gang RACO 944 box or equal, 2-1/2" deep (supplied separately)

**LCD Annunciator Assembly**

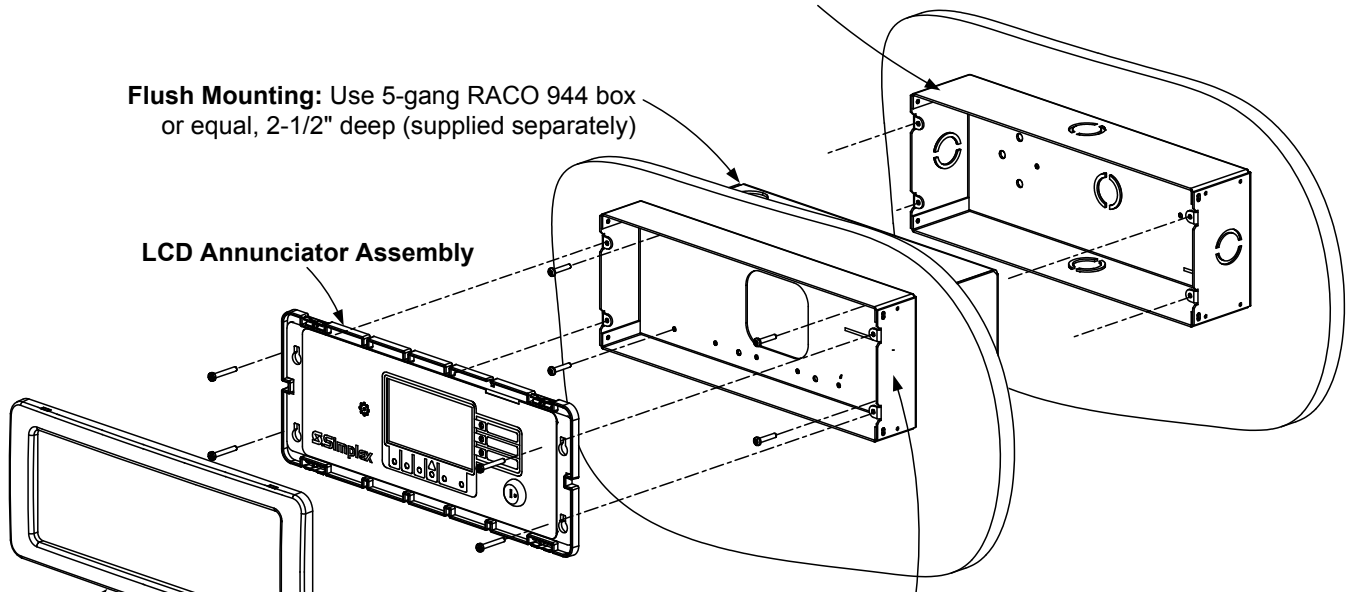

**Trim Plate** (supplied)

**Semi-Flush Mounting:** Use Simplex Semi-Flush Box Adapter Model 2975-9463 (red) or 2975-9464 (platinum), 1-3/4" deep (44 mm) (ordered separately); use for mounting on existing 2-gang, 4-gang, 6-gang, or 4" square flush mounted electrical boxes (supplied separately)

## Wiring Reference

### Interconnection Wiring Notes:

1. Communications require 18 to 12 AWG unshielded twisted pair.
2. Power requires two, 18 to 12 AWG wires for 24 VDC system power, plus Earth Ground to each electrical box.
3. Refer to Installation Instructions 579-1172 for additional wiring specifications.



4007ES Fire Alarm Control Panel



4606-9202 LCD Annunciators

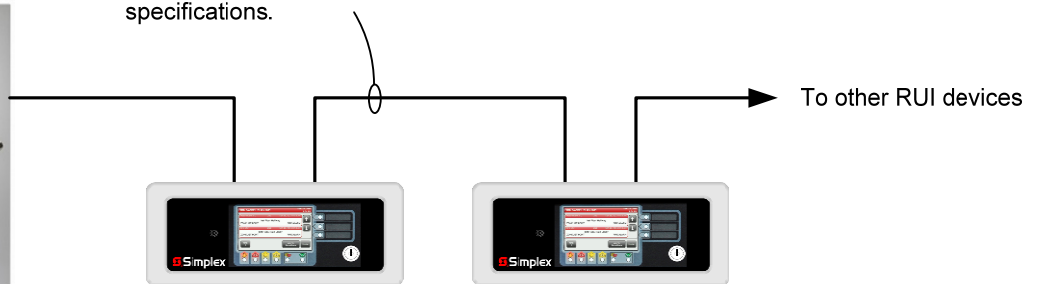

*TYCO, SIMPLEX, and the product names listed in this material are marks and/or registered marks. Unauthorized use is strictly prohibited. National Electrical Code and NFPA are registered trademarks of the National Fire Protection Association (NFPA).*



Tyco Fire Protection Products • Westminister, MA • 01441-0001 • USA  
[www.simplex-fire.com](http://www.simplex-fire.com)

S4606-0003-2 1/2017

© 2017 Tyco Fire Protection Products. All rights reserved. All specifications and other information shown were current as of document revision date and are subject to change without notice.